

domo

C. RÉSISTANCE
JUSQU'À C250
Selon NORME EN-1433

LOAD CLASS
UP TO C250
Standard EN-1433

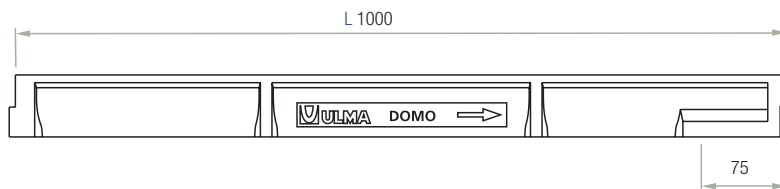
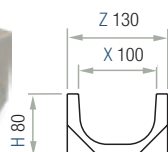
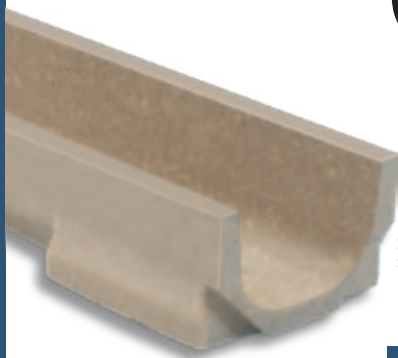

CODE	L (mm)	H (mm)	LARGEUR / WIDTH (mm)		Ø SORTIE / OUTLET (mm)		HIDRAUL. SECTION (cm²)	KG	UNITÉS x PALETTE PCS x PALLET
			Z	X	Vert.	Horiz.			
DOMO	1000	80	130	100	110	-	60	6,5	120

*Sortie vert. et horiz. sur commande. / Vert. and horiz. outlets on order.

DESCRIPTIF TECHNIQUE

Caniveau en béton polymère de type ULMA, modèle DOMO, largeur extérieure 130mm, largeur intérieure 100mm, hauteur extérieure 80mm, pour récupérer les eaux de pluie, en modules de 1 ML de longueur, système de fixation avec 2 vis par ML, adapté pour les grilles suivantes:

TECHNICAL DESCRIPTION

ULMA Linear Drainage Channel type DOMO: External width 130mm; Internal width 100mm and overall height 80mm to collect rain water in 1 metre long units. The locking system consists of 2 screws per metre. Suitable for the following gratings:

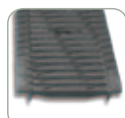

Nervurée / Slotted

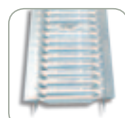

Passerelle / Slotted

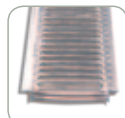

Passerelle / Slotted

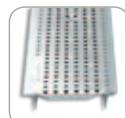

Perforée / Perforated

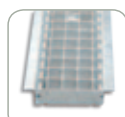

Caillebotis / Mesh
Normal et Antitalon
Normal & Heelproof

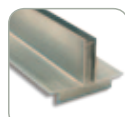

Fente / Single Slot

GRILLES / GRATINGS

MATIÈRE MATERIAL	DESSIN DESIGN	RESIST. LOAD	CODE	L. (mm)	LARGEUR WIDTH (mm)	ÉPAISSEUR THICKNESS (mm)	UNITÉS x ML UNITS x ML	KG.
FONTE DUCTIL IRON	NERV. / SLOT.	B125	FNX100UCBM (1)	500	130	6	2	2,1
	NERV. / SLOT.	C 250	FNX100UCCM (1)	500	130	6	2	2,3
ACIER GALVANISÉ GALVANISED STEEL	PASS. / SLOT.	A 15	GN100UCA	1000	130	3	1	1,8
	PASS. / SLOT.	A 15	GN100UOA (2)	1000	127	3	1	1,5
	PERF.	A 15	GP100UCA	1000	130	3	1	1,9
	CAIL. / MESH	B 125	GEX100UCB33	1000	130	2	1	3,1
	CAIL. / MESH	B 125	GEHX100UCB	1000	130	2	1	3,8
	FENTE / S. SLOT.	C 250	GR100UOC (2)	1000	130	70	1	4,3
INOXYDABLE STAINLESS STEEL	FENTE / DOUBLE / SLOT.	C 250	GDR100UOC (2)	1000	130	70	1	5,4
	PASS. / SLOT.	A 15	IN100UCA	1000	130	3	1	1,9
	PERF.	A 15	IP100UCA	1000	130	3	1	1,9
	CAIL. / MESH	B 125	IEX100UCB	1000	130	3	1	3,2

(1) Disponible avec système antidébordement (Voir la photographie à la page 11) / Also available with non-flooding system (See photograph on page. 11).

(2) Posée, sans vis. / Without screws.

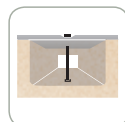

SYSTÈME DE FIXATION / LOCKING SYSTEM

AVEC VIS À LA BASE DU CANIVEAU. Deux vis par mètre linéaire.
SCREW LOCKING SYSTEM. 2 screws per metre.



AEURO100



AU100

AVALOIR ET ACCESSOIRES / SUMP UNITS AND ACCESSORIES TABLE

CODE	L. (mm)	H. (mm)	LARGEUR WIDTH (mm)	Ø SORTIE / OUTLET (mm)		CORPS SUMP UNITS	PANIER BUCKET
				LATERAL	FRONT		
AEURO100	500	300	130	90/110	90	1	CEURO100
AU100	500	542	130	110/160	90	1	CU100

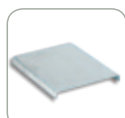

Fermé / Closed

OBTURATEURS / END CAPS

CODE	TYPE
TD0M0100C	FERMÉ / CLOSED



PANIER / GALVANISED STEEL BUCKET

CODE
CEURO100