

# self200

C.RÉSISTANCE  
JUSQU'À C250  
Selon NORME EN-1433

LOAD CLASS  
UP TO C250  
Standard EN-1433

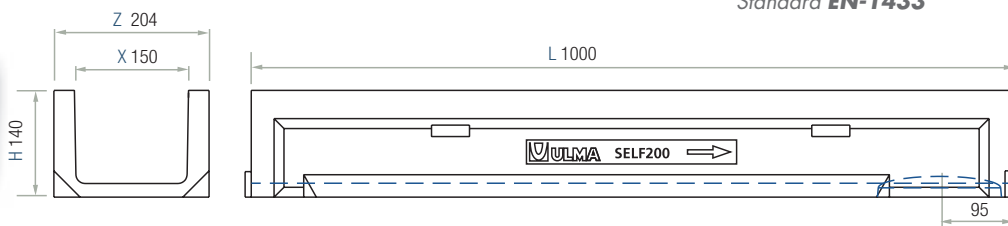

CODE	L (mm)	H (mm)	LARGEUR/WIDTH (mm)		Ø SORTIE/OUTLET (mm)		HIDRAUL. SECTION (cm²)	KG	UNITÉS x PALETTE PCS x PALLET
			Z	X	Vert.	Horiz.			
SELF200	1000	140	204	150	160	-	180	14,5	54

\*Sortie vert. et horiz. sur commande. / Vert. and horiz. outlets on order.

## DESCRIPTIF TECHNIQUE

Caniveau en béton polymère de type ULMA, modèle SELF200, largeur extérieure 204mm, largeur intérieure 150mm, hauteur extérieure 140mm, pour récupérer les eaux de pluie, en modules de 1 ML de longueur, clavette de sécurité CS150 et vis correspondantes, adapté pour les grilles suivantes:

## TECHNICAL DESCRIPTION

ULMA Linear Drainage Channel type SELF200: External width 204mm; Internal width 150mm and overall height 140mm to collect rain water in 1 metre long units. Locking system consists of locking bar CS150 and screws. Suitable for the following gratings:

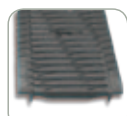

Nervurée / Slotted

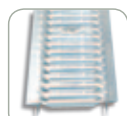

Passerelle / Slotted

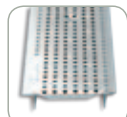

Perforée / Perforated

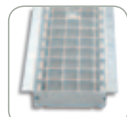

Caillebotis / Mesh Normal et Antitalon Normal & Heelproof

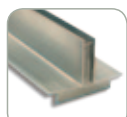

Fente / Single Slot

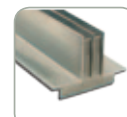

Fente / Double/ Slot

## GRILLES / GRATINGS

MATIÈRE MATERIAL	DESSIN DESIGN	RESIST. LOAD	CODE	L. (mm)	LARGEUR WIDTH (mm)	ÉPAISSEUR THICKNESS (mm)	UNITÉS x ML UNITS x ML	KG.
FONTE DUCTIL IRON	NERV. / SLOT.	B 125	FNX150UCBM (1)	500	200	6	2	4
	NERV. / SLOT.	C 250	FNX150UCCM (1)	500	200	5	2	3,5
ACIER GALVANISÉ GALVANISED STEEL	PASS. / SLOT.	A 15	GN150UCA	1000	200	3	1	2,7
	PERF.	A 15	GP150UCA	1000	200	3	1	3,7
	CAIL. / MESH	B 125	GEX150UCB33	1000	200	2	1	4,9
	CAIL. / MESH	B 125	GEHX150UCB	1000	200	2	1	6
	FENTE / S. SLOT.	C 250	GR150UOC (2)	1000	200	70	1	5,8
	FENTE / DOUBLE / SLOT.	C 250	GDR150UOC (2)	1000	200	70	1	6,8
INOXYDABLE STAINLESS STEEL	PERF.	A 15	IP150UCA	1000	200	3	1	3
	CAIL. / MESH	B 125	IEX150UCB	1000	200	3	1	6

(1) Disponible avec système antidébordement (Voir la photographie à la page 11) / Also available with non-flooding system (See photograph on page. 11).  
(2) Posée, sans vis. / Without screws.

## SYSTÈME DE FIXATION / LOCKING SYSTEM



AVEC CLAVETTES. Deux clavettes et deux vis par mètre linéaire.  
LOCKING BAR. Two locking bars and two screws per linear metre.

## AVALOIR ET ACCESSOIRES / SUMP UNITS AND ACCESSORIES TABLE



ASELF200

CODE	L. (mm)	H. (mm)	LARGEUR WIDTH (mm)	Ø SORTIE / OUTLET (mm)		CORPS SUMP UNITS	PANIER BUCKET
				LATERAL	FRONT		
ASELF200	500	378	204	160/200	160	1	CSELF200

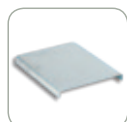

Fermé / Closed

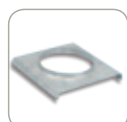

Ouvert / Open

## OBTURATEURS / END CAPS

CODE	TYPE	Ø (mm)
TSELF200C	FERMÉ / CLOSED	-
TSELF200A	OUVERT / OPEN	110



## PANIER / GALVANISED STEEL BUCKET

CODE
CSELF200